

Pneumatisk slangeventiler serie VM

Muffeudførelse DN10-50

Air operated Pinch Valves of VM Series

Socket type DN10-50

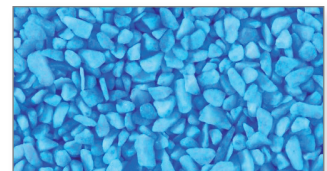

▲ Den optimale armaturløsning for slibende, ætsende og fiberholdige produkter som f.eks. granulater, pulver, opløsninger, slam, støv m.m.

Industriområder:

- Vinindustri
 - Farmaindustri
 - Levnedsmiddelindustri
 - Drikkevareindustri
 - Kemisk industri
 - Offshore industri
- og meget mere

▲ The ideal valve solution for abrasive, corrosive and fibrous products like granules, powders, suspensions, sludge/slurries, dust and so on.

Industrial areas:

- Wine Industry
 - Pharmaceutical Industry
 - Food Industry
 - Beverage Industry
 - Chemical Industry
 - Offshore Industry
- and many more

Pneumatisk slangeventiler serie VM

Air operated Pinch Valves of VM Series

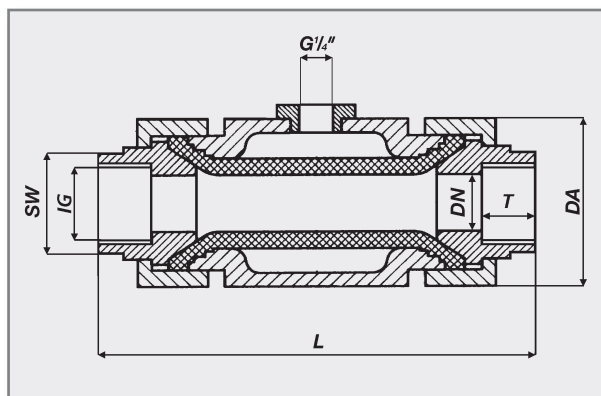

- Frit produktflow
- Optimal tætning
- Minimal gnidningsmodstand
- Ingen tilstopning
- Lav vægt

- Free passage
- Optimum tightness
- Low resistance
- No plugging
- Low weight

DN (mm)	IG (inch)	T (mm)	SW (mm)	L (mm)	DA (mm)	PS max. (bar)
10	G $\frac{3}{8}$ "	16	24	122	46	6
15	G $\frac{1}{2}$ "	18	36	134	60	6
20	G $\frac{3}{4}$ "	19	36	140	60	6
25	G1"	20	46	145	75	6
32	G1 $\frac{1}{4}$ "	25	52	170	85	6
40	G1 $\frac{1}{2}$ "	26	65	200	100	6
50	G2"	24	80	213	120	6

Materialier:

Ventilhus:

PVC

Aluminium + Rustfri stål på forespørgsel

Gevinddæksel:

PVC,

Rustfri stål, POM på forespørgsel

Membraner:

Naturgummi (NR) slibefast, NR fødevarer, NBR, NBR fødevarer, EPDM, EPDM fødevarer, silikone, FPM, CR, CSM

Min. differencetryk til lukning af ventilen:

2-4 bar (varierer efter nominal bredde/elastomer)

Yderligere tilbehør og information findes i vores datablad "Tilbehør for armaturer".

Materials:

Valve body:

PVC

Aluminium, stainless steel upon request

Socket:

PVC,

Stainless steel, POM upon request.

Sleeves:

Natural rubber (NR) anti-abrasive, NR food quality, NBR, NBR food, EPDM, EPDM food, silicone, FPM, CR, CSM

Min. differential pressure to close the valve:

2-4 bar (varies depending on diameter/sleeve)

Pinch Valve Accessories to be found on our data sheet "Pinch Valve Accessories".

Tekniske ændringer forbeholdes.

Technical details subject to change without notice.

AKO Armaturen & Separationstechnik GmbH

D-65468 Trebur-Astheim • Adam-Opel-Str. 5 • Telefon/Phone: +49 (0) 61 47-9159-0 • Fax: +49 (0) 61 47-9159-59
E-Mail: ako@ako-armaturen.de • Internet: www.slangeventiler.dk / www.pinch-valve.com